

Video

Scan our QR Code with your smart phone to watch the instructions online.



• Before Starting:

Wash or sanitize your hands. Make sure they are dry before starting.

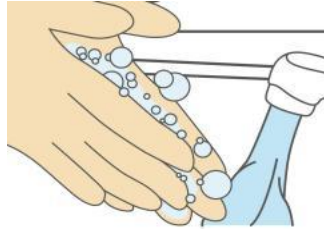

A. PREPARE FOR THE TEST

1. Remove the components from the box and identify the kit components.

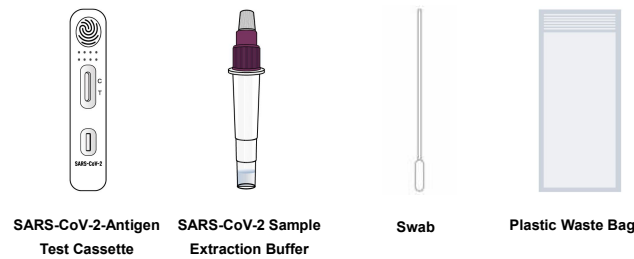

2. Put the bottom of the kit packing box upright. You can see the circle(s), and then squeeze the paper out to make a tube holder.

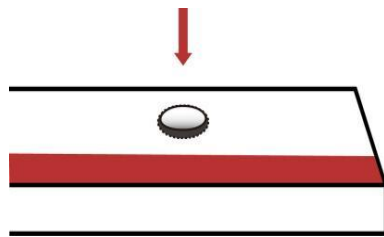

3. Remove the purple cap from extraction tube and place it in the tube holder.

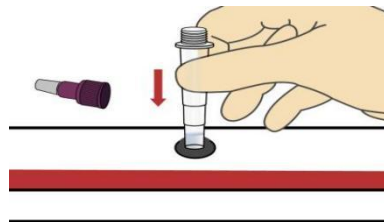

B. THE COLLECTION METHOD OF NASAL SWAB

! DO NOT TOUCH THE SWAB HEAD

4. Take the Swab out.

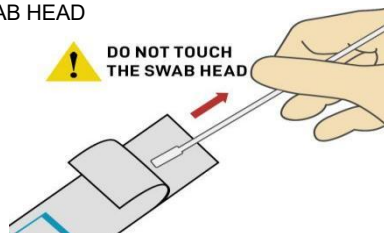

5. Carefully insert the Swab into left nostril about 2.0 cm.

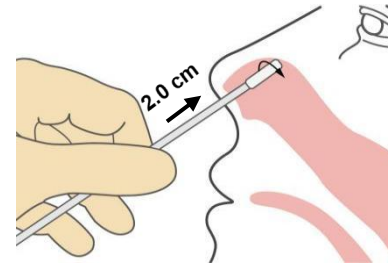

6. Rotate the Swab, 5 times for the left nostril to ensure sufficient specimen collection.

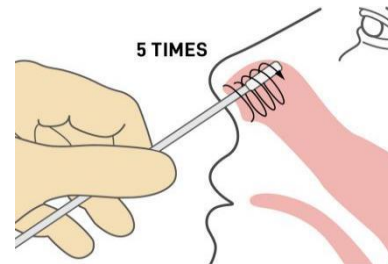

7. Using the same Swab, repeat step 5 and step 6 in your right nostril.

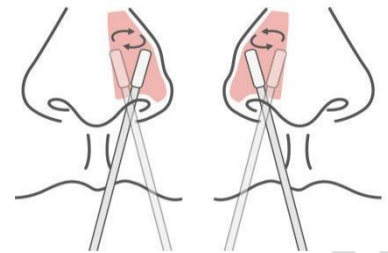

C. TEST PROCEDURE

! Please read the instructions carefully before testing. Samples to be tested, test reagents, and other test materials shall be balanced to room temperature. The test shall be conducted at room temperature.

8. Place the Swab into the extraction tube filled with SARS-CoV-2 Sample Extraction Buffer. Stir Swab in the liquid for 10 times. Hold and squeeze the tube to mix the Swab and SARS-CoV-2 Sample Extraction Buffer well.

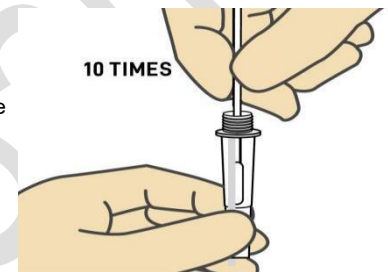

9. Squeeze out as much liquid as possible from the Swab and remove.

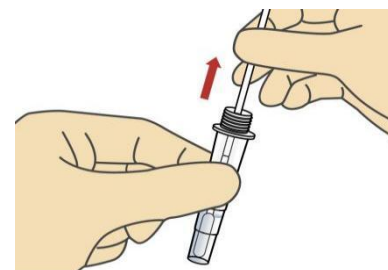

10. Screw up the purple cap tight onto the tube. Shake it gently for 10 times, and be careful not to turn it upside down, to mix the liquid thoroughly.

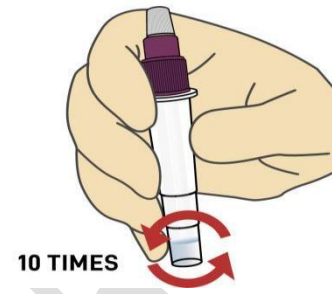

11. Take out the SARS-CoV-2-Antigen Test Cassette from the foil bag and place it flat on the table.



12. Remove the white cap off the extraction tube and turn the tube with samples upside down. Add 3 drops of processed sample to the sample window, and time it.

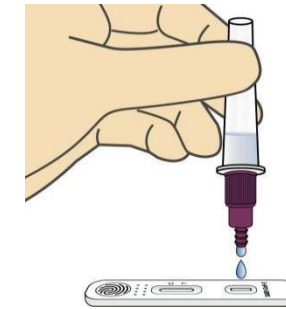

13. Read the test results within 15~20 minutes, and the test results have no clinical significance after 20 minutes.

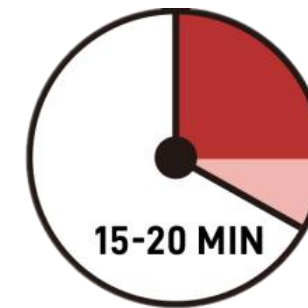

Note

Keep SARS-CoV-2-Antigen Test Cassette in sealed foil pouch prior to use. The cassette should be used within 120 minutes once the foil pouch is opened. If the temperature is higher than 30°C or under conditions of high humidity (>70%RH), It should be used immediately after the foil pouch is opened.

Interpretation of Test Results

Find result window and look carefully for red bands to appear.

Note: There should be no red lines on the test card before use.

Positive:

If you watch red bands appearing at both test band (T) and control band (C). This means that the sample contains SARS-CoV-2 antigen.

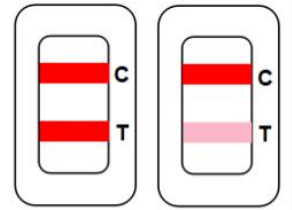

Note: Look Closely! Samples with low levels of antigen may give a faint sample line. **Even if the test line is very faint or not uniform the test result should be interpreted as a positive result.**

Negative:

If you watch a red band appearing at control band (C) only, it means SARS-CoV-2 antigen is not detected.

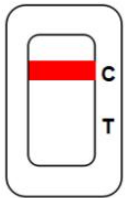

Note: negative test result does not eliminate the possibility of SARS-CoV-2 infection, and should be confirmed by viral culture or a molecular assay if necessary for patient management.

Invalid:

No visible red band appear at control band (C). The test procedures may not be followed correctly, or the cassette is deteriorated. It is recommended to retest. Please perform a new test with a new sample and a new test cassette.

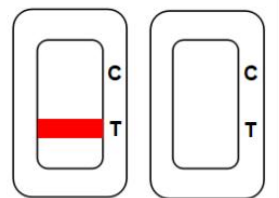

Disposal

1. Dispose of kit components including the swabs in Plastic Waste Bag which it provided in the kit.
2. Dispose of the Plastic Waste Bag in household trash.